

HS-880TAB VACUUM SERIES

Plate Materials : POM-DP,POM-LF

Pin Material : Cold rolled austenitic stainless steel



Materials



Sprockets



Applications

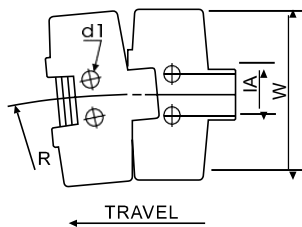
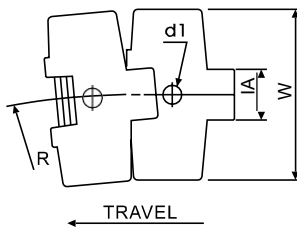
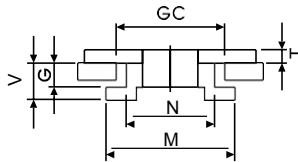
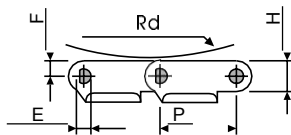
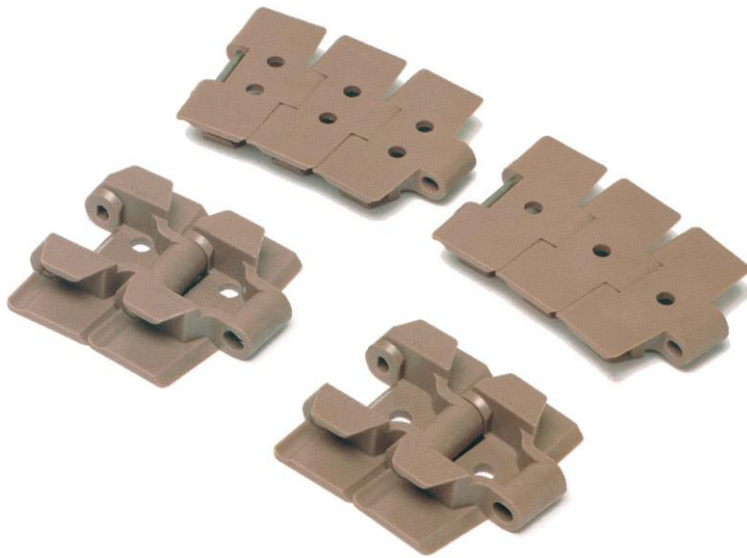

Dimension	mm	inches
P	38.1	1.500
W	—	—
H	20.0	0.787
T	4.0	0.157
E	6.4	0.281
M	61.1	2.406
F	7.6	0.300
V	11.5	0.453
N	42.9	1.689
RD	40.0	1.575
GC(Straight)	46.0	1.812
GC(Curve)	44.2	1.740

HS-880TAB VACUUM (Side Flexing Plastic Chain)

CHARACTERISTICS

	Width W		Working Load		d1	R		I _A		Weight
	(mm)	(inch)	N(21°C)	lbs(21°C)	(mm)	(mm)	(inch)	(mm)	(inch)	(kg/m)
HS-880TAB-K325 B1	82.5	3.25	2100	472	5/6/6.5	457	17.99	—	—	0.94
					8/9.5/10					
HS-828TAB-K325 B2	82.5	3.25	2100	472	6/8	457	17.99	24/20	0.95	0.94
HS-828TAB-K450 B2	114.3	4.50	2100	472	6	457	17.99	24	0.95	1.08

*I_A=Distance between centres.

*B1=one bore B2=two bores