

HS-878-EL BO SERIES



Materials



Sprockets



Applications

Plate Materials: POM-DP,POM-LF

Pin Material: Cold rolled austenitic stainless steel

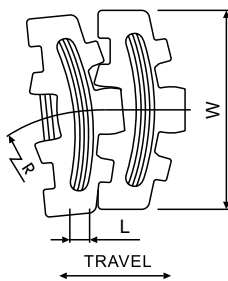
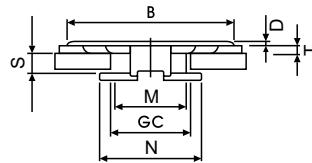
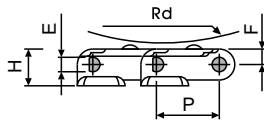
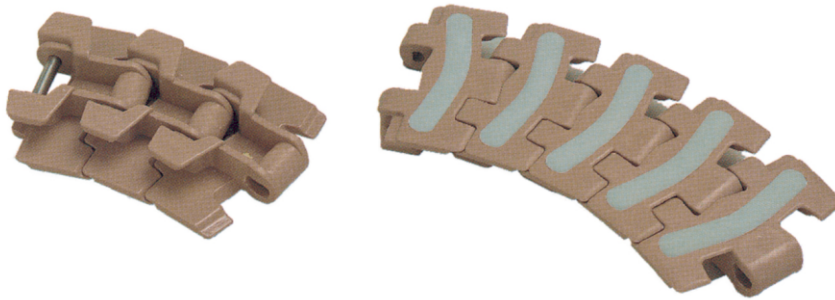

Dimension	mm	inches
P	38.1	1.500
W	-	-
E	7.1	0.280
T	4.0	0.157
F	8.4	0.329
M	42.9	1.689
N	61.5	2.241
D	2.0	0.079
L	11.4	0.449
H	20.8	0.819
R	190.0	7.480
S	11.5	0.453
RD	40.0	1.575
GC(Straight)	46.0	1.811
GC(Curve)	44.2	1.740

B:132.0/195. 0/246.0

HS-878-EL BO (Side Flexing Plastic Chain)

CHARACTERISTICS

	Width W (mm)	Width W (inch)	Working Load N(21°C)	Working Load lbs(21°C)	Radius (mm)	Radius (inch)	Reverse Radius (mm)	Reverse Radius (inch)	Weight (kg/m)
HS-878-EL BO-K325	82.5	3.25	2100	472	190	7.48	40	1.575	1.08
HS-878-EL BO-K450	114.5	4.50	2100	472	190	7.48	40	1.575	1.20