

HS-1873D SERIES

Plate Materials: POM-DP,POM-LF  
Base Chain Material: Carbon steel, Stainless steel



Materials



Sprockets



Applications

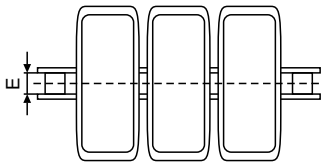
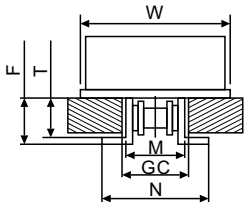
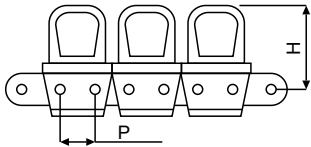

Dimension	mm	inches
P	19.05	0.750
M	32.0	1.260
W	—	—
H	42.6	1.654
T	20.6	0.787
F	24.5	0.965
N	55.0	2.165
E	12.7	0.472
GC(Straight)	33.3	1.311
GC(Curve)	34.9	1.374

HS-1873D (Side Flexing Plastic Chain)

CHARACTERISTICS									
	Width W		Working Load		Radius		Reverse Radius		Weight
	(mm)	(inch)	N(21℃)	lbs(21℃)	(mm)	(inch)	(mm)	(inch)	(kg/m)
HS-1873D-K325	82.6	3.25	3400	765	356	14.0	305	24.0	2.90
HS-1873D-K450	114.3	4.50	3400	765	356	14.0	305	24.0	3.50
HS-1873D-K600	152.4	6.00	3400	765	457	18.0	305	24.0	4.10
HS-1873D-K750	190.5	7.50	3400	765	457	18.0	305	24.0	4.50

\*The above tensile force is for Carbon steel,Please consult our engineer for that of Stainless steel.