

HS-881 SERIES



Materials



Sprockets



Applications

Plate Materials: S, SS

Pin Material: Case hardened seetl(for carbon steel chains)
Cold rolled austenitic stainless steel(for stainless steel chains)

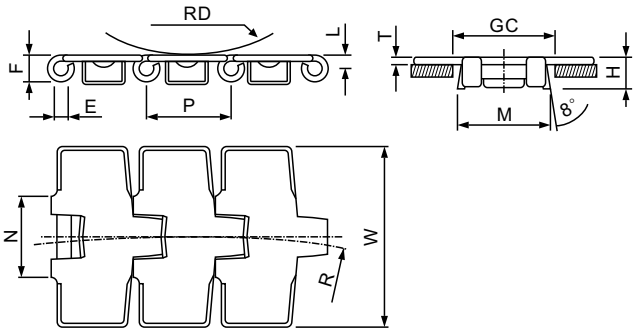

Dimension	mm	inches
P	38.1	1.500
T	3.0	0.118
M	43.0	1.693
N	38.3	1.508
L	6.4	0.252
H	14.5	0.571
E	6.4	0.250
F	13.0	0.512
RD	75.0	2.953
GC(Straight)	44.5	1.752
GC(Curve)	41.5	1.634

HS-881 (Sideflexing-Bevel)

	Width W		Working Load		Sideflexing Radius		Weight (kg/m)
	(mm)	(inch)	N(21°C)	lbs(21°C)	(mm)	(inch)	
HS-S 881 K3 1/4	82.6	3.25	11600	2610	457.2	18	2.74
HS-S 881 K4 1/2	114.3	4.50	11600	2610	609.6	24	3.37
HS-S 881 K7 1/2	190.5	7.50	11600	2610	609.6	24	4.78
HS-SS 881 K3 1/4	82.6	3.25	5600	1260	457.2	18	2.76
HS-SS 881 K4 1/2	114.3	4.50	5600	1260	609.6	24	3.40
HS-SS 881 K7 1/2	190.5	7.50	5600	1260	609.6	24	4.82