

HS-981TAB SERIES

Plate Materials: P

Pin Material: Cold rolled austenitic stainless steel



Materials



Sprockets



Applications

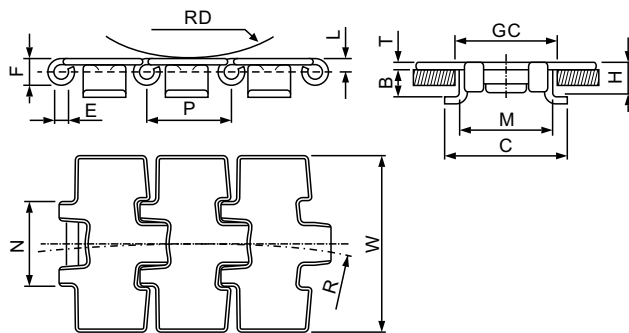

Dimension	mm	inches
P	38.1	1.500
T	3.0	0.118
M	43.0	1.693
N	38.3	1.508
C	56.0	2.205
L	6.4	0.252
H	19.3	0.760
E	6.4	0.250
B	12.8	0.504
F	13.0	0.512
RD	75.0	2.953
GC(Straight)	46.0	1.811
GC(Curve)	44.5	1.752

HS-981TAB (Sideflexing-Tab-Reduced plate gap)

CHARACTERISTICS

	Width W		Working Load		Sideflexing Radius		Weight
	(mm)	(inch)	N(21°C)	lbs(21°C)	(mm)	(inch)	(kg/m)
HS-P 981TAB K3 1/4	82.6	3.25	8000	1800	457.2	18	2.95
HS-P 981TAB K83.8	83.8	3.30	8000	1800	457.2	18	2.96
HS-P 981TAB K4 1/2	114.3	4.50	8000	1800	609.6	24	3.58
HS-P 981TAB K7 1/2	190.5	7.50	8000	1800	609.6	24	4.99