

HS-2815-EL SERIES

Plate Materials: P
Pad Material: Nitrilic rubber PG
Pin Material: Cold rolled austenitic stainless steel



Materials



Sprockets



Applications

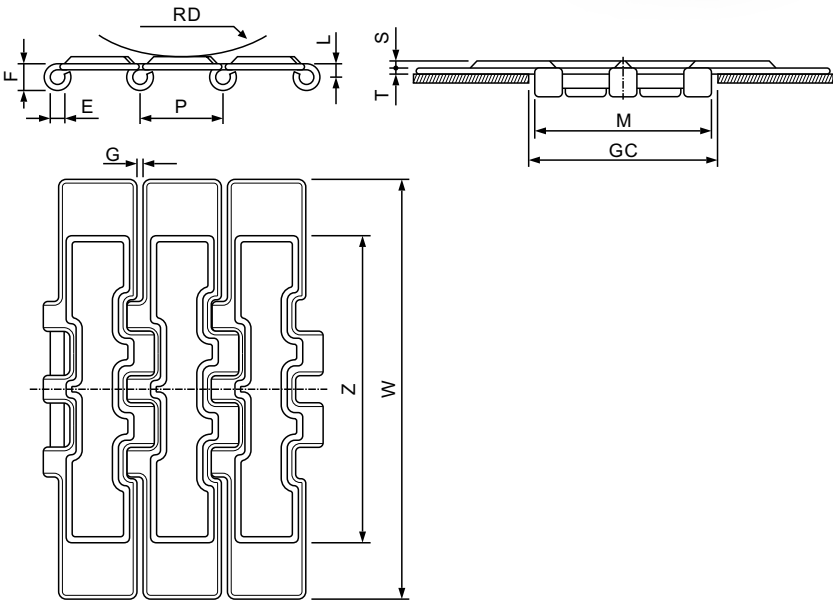
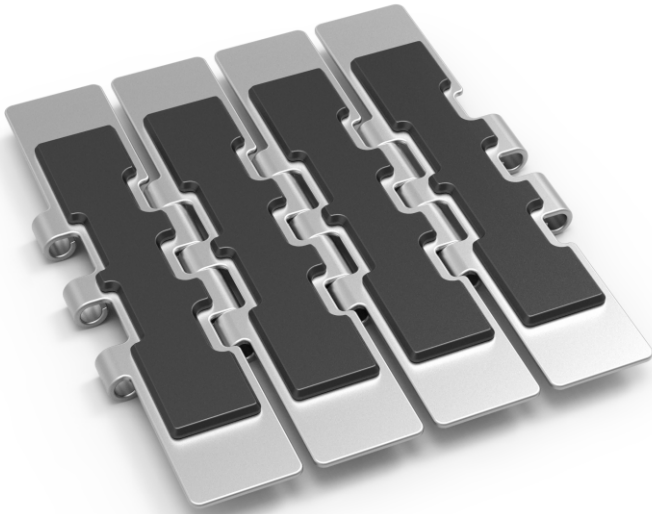

Dimension	mm	inches
P	38.1	1.500
T	3.0	0.118
S	3.0	0.118
M	80.0	3.150
L	6.4	0.252
H	13.0	0.512
E	6.4	0.250
Z	140.0	5.512
G	1.8	0.071
RD	150.0	5.906
GC	82.5	3.248

HS-2815-EL (Straight Running-Double Hinge-Rubberized Surface)

CHARACTERISTICS							
	Width W		Working Load		Sideflexing Radius		Weight (kg/m)
	(mm)	(inch)	N(21℃)	lbs(21℃)	(mm)	(inch)	
HS-2815-EL K7 1½	190.5	7.50	15000	3375	–	–	5.94