

HS-HD 9857M-EL SERIES

Plate Materials: P  
Pad Material: Nitrilic rubber PG  
Pin Material: Cold rolled austenitic stainless steel



Materials



Sprockets



Applications

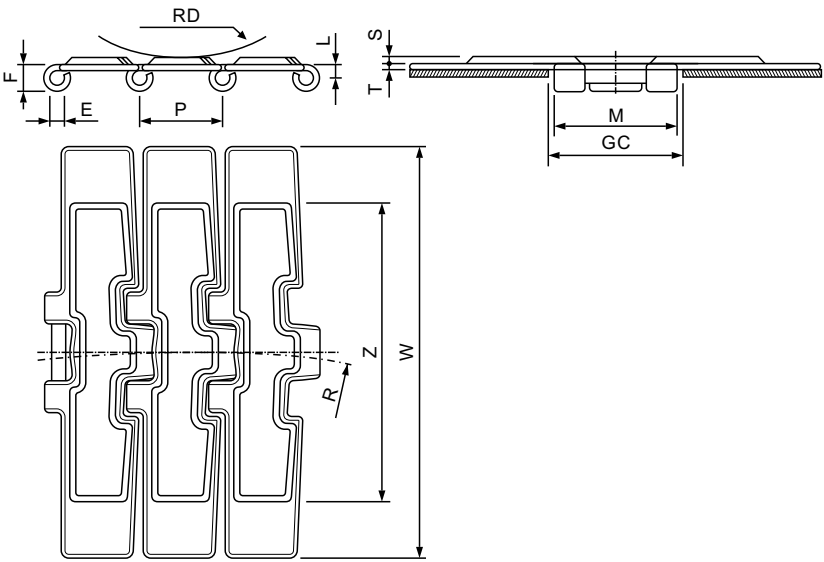
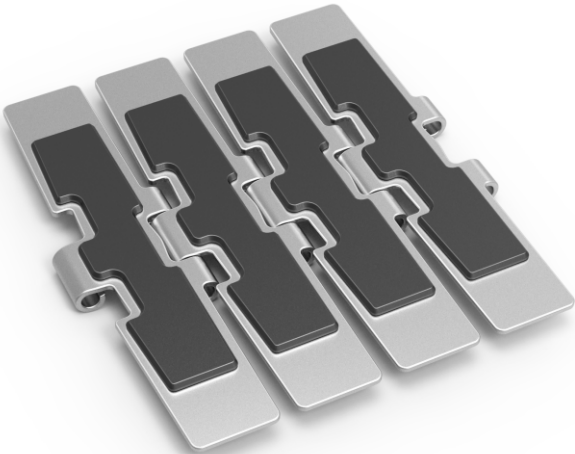

Dimension	mm	inches
P	38.1	1.500
T	3.0	0.118
S	3.0	0.118
M	57.0	2.244
L	6.4	0.252
H	13.0	0.512
E	6.4	0.250
Z	139.5	5.492
RD	75.0	2.953
GC(Straight)	60.0	2.362
GC(Curve)	60.0	2.362

HS-HD 9857M-EL (Sideflexing-Magnetic-Heavy Duty Single Hinge-Increased Pin Hardness-Rubberized Surface)

CHARACTERISTICS							
	Width W		Working Load		Sideflexing Radius		Weight (kg/m)
	(mm)	(inch)	N(21℃)	lbs(21℃)	(mm)	(inch)	
HS-HD 9857M-EL K7¼	190.5	7.50	10500	2363	750	29.528	5.26